

1
Isometric - Detail Map - Tactile Porcelain Enamel™ Metal Cladding
 Scale: No Scale

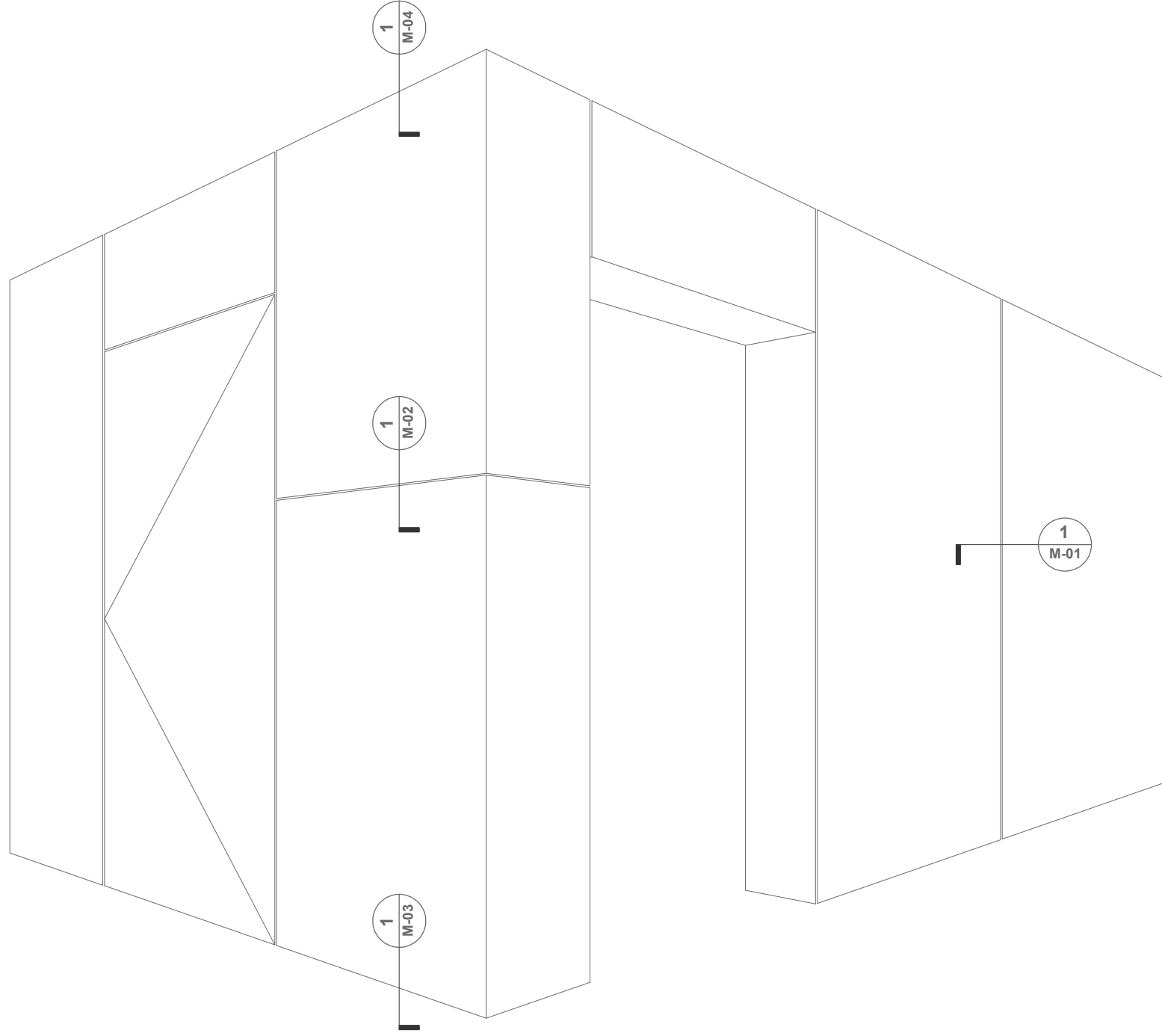

SHEET NO. M-00	REVISIONS			PROJECT#	ARCHITECT	CLIENT
	SCALE AS NOTED	DESCRIPTION	DATE			
DRAWN BY JO				Tactile Porcelain Enamel™ Metal Cladding Details Interior Cladding		
APPROVED BY SE						
ISSUE DATE 11/05/2019						

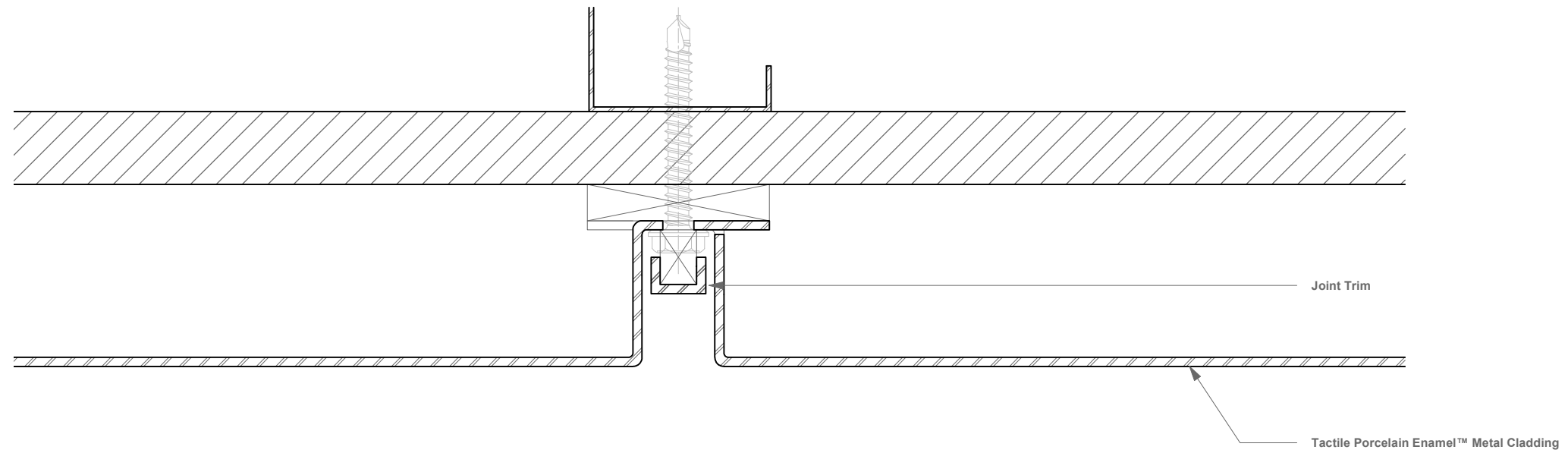

1 Plan - Typical Vertical Joint - Tactile Porcelain Enamel™ Metal Cladding
 M-01 Scale: Full Scale

SHEET NO. M-01	REVISIONS			PROJECT# Tactile Porcelain Enamel™ Metal Cladding Details Interior Cladding	ARCHITECT	CLIENT
	SCALE AS NOTED	DESCRIPTION	DATE			
DRAWN BY JO						
APPROVED BY SE						
ISSUE DATE 11/05/2019						

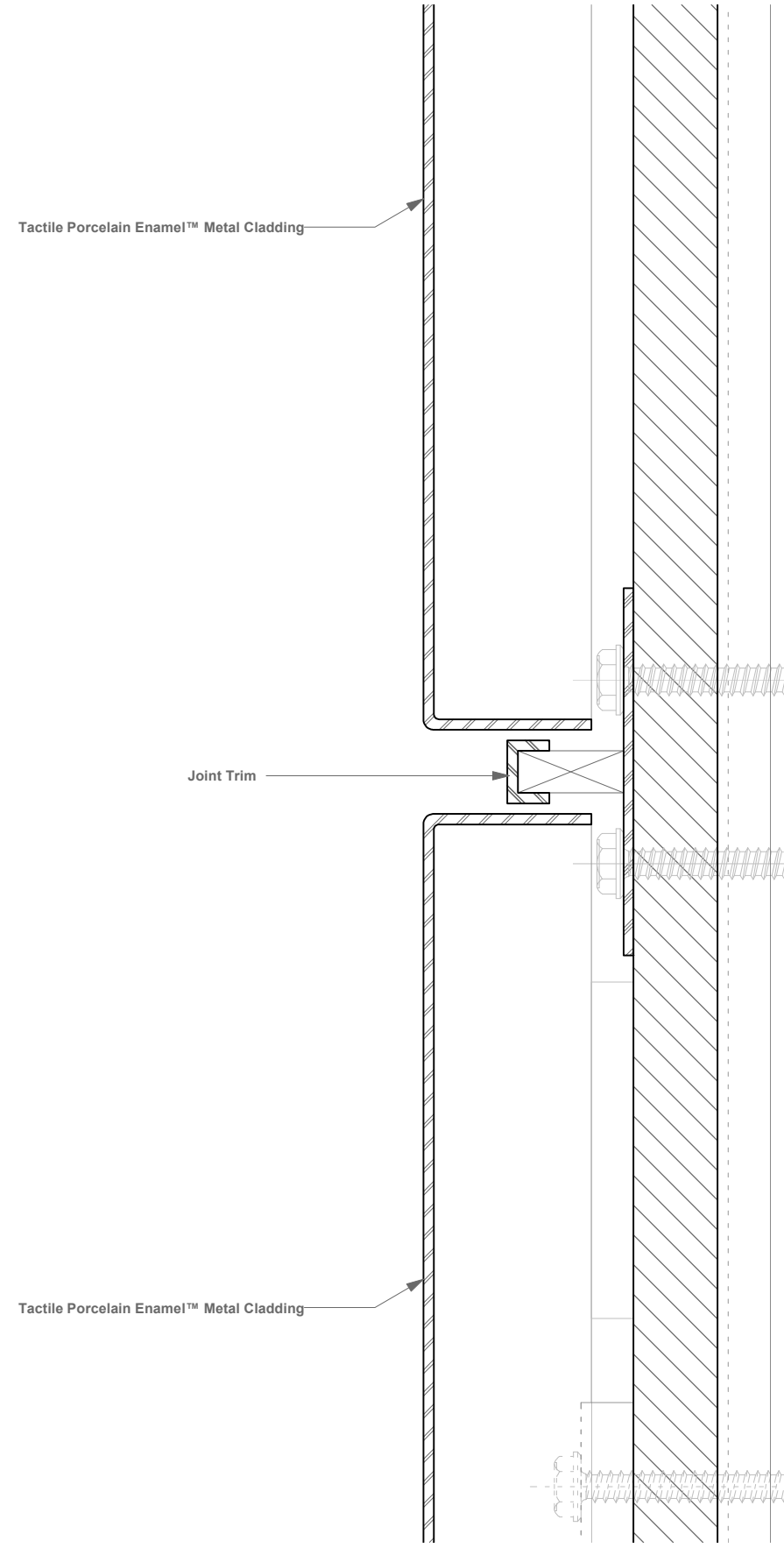

1 Section - Typical Horizontal Joint - Tactile Porcelain Enamel™ Metal Cladding
 M-02 Scale: Full Scale

SHEET NO. M-02	REVISIONS		PROJECT#	ARCHITECT	CLIENT
	SCALE AS NOTED	DESCRIPTION			
DRAWN BY JO	DATE	APPROVED			
APPROVED BY SE					
ISSUE DATE 11/05/2019					

1
M-03

Section - Typical Horizontal Joint at Ground - Tactile Porcelain Enamel™ Metal Cladding
Scale: Full Scale

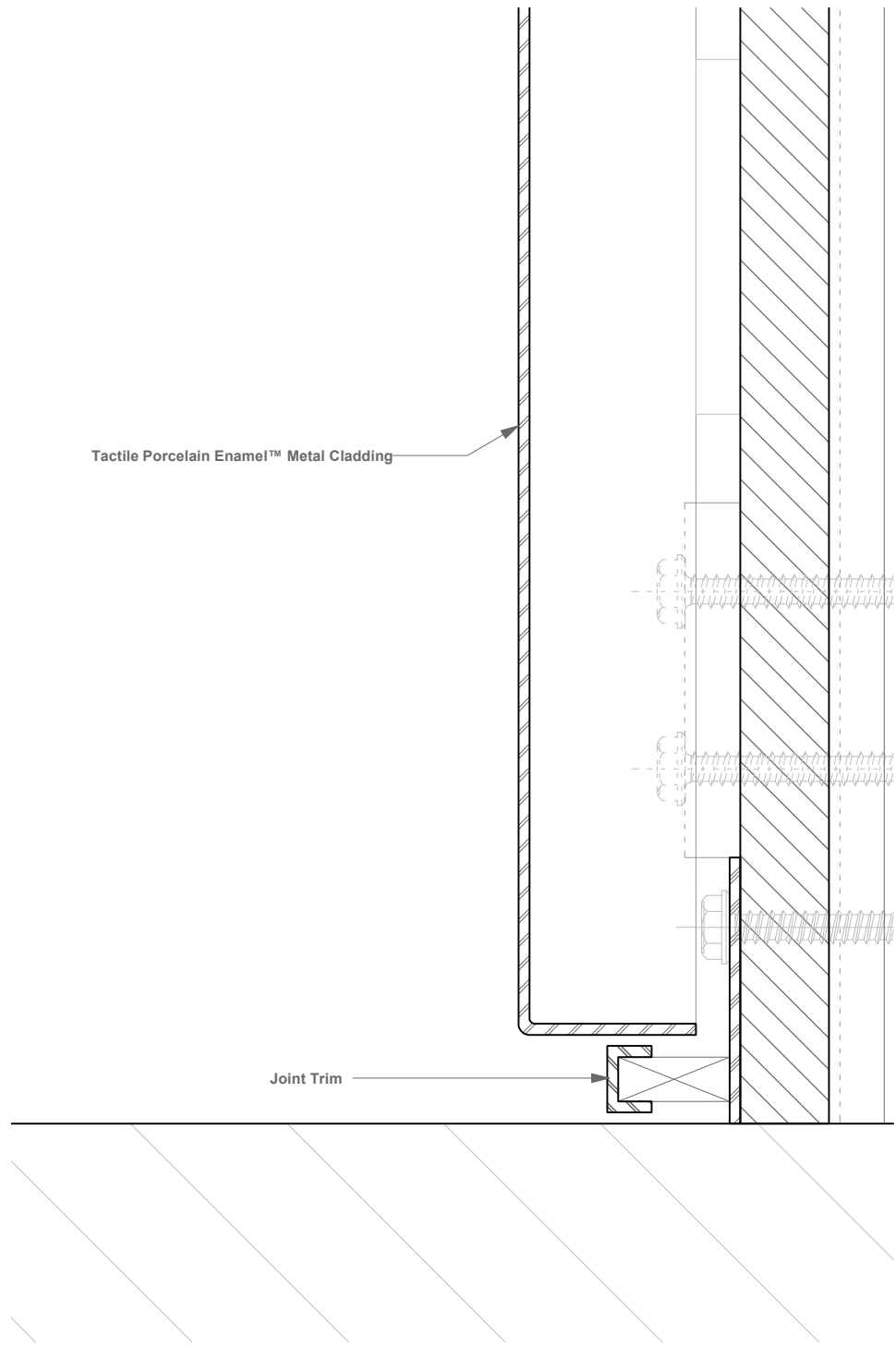

SHEET NO. M-03	SCALE AS NOTED	DRAWN BY JO	APPROVED BY SE	ISSUE DATE 11/05/2019	REVISIONS			PROJECT#	ARCHITECT	CLIENT
					REV	DESCRIPTION	DATE			
								Tactile Porcelain Enamel™ Metal Cladding Details Interior Cladding		

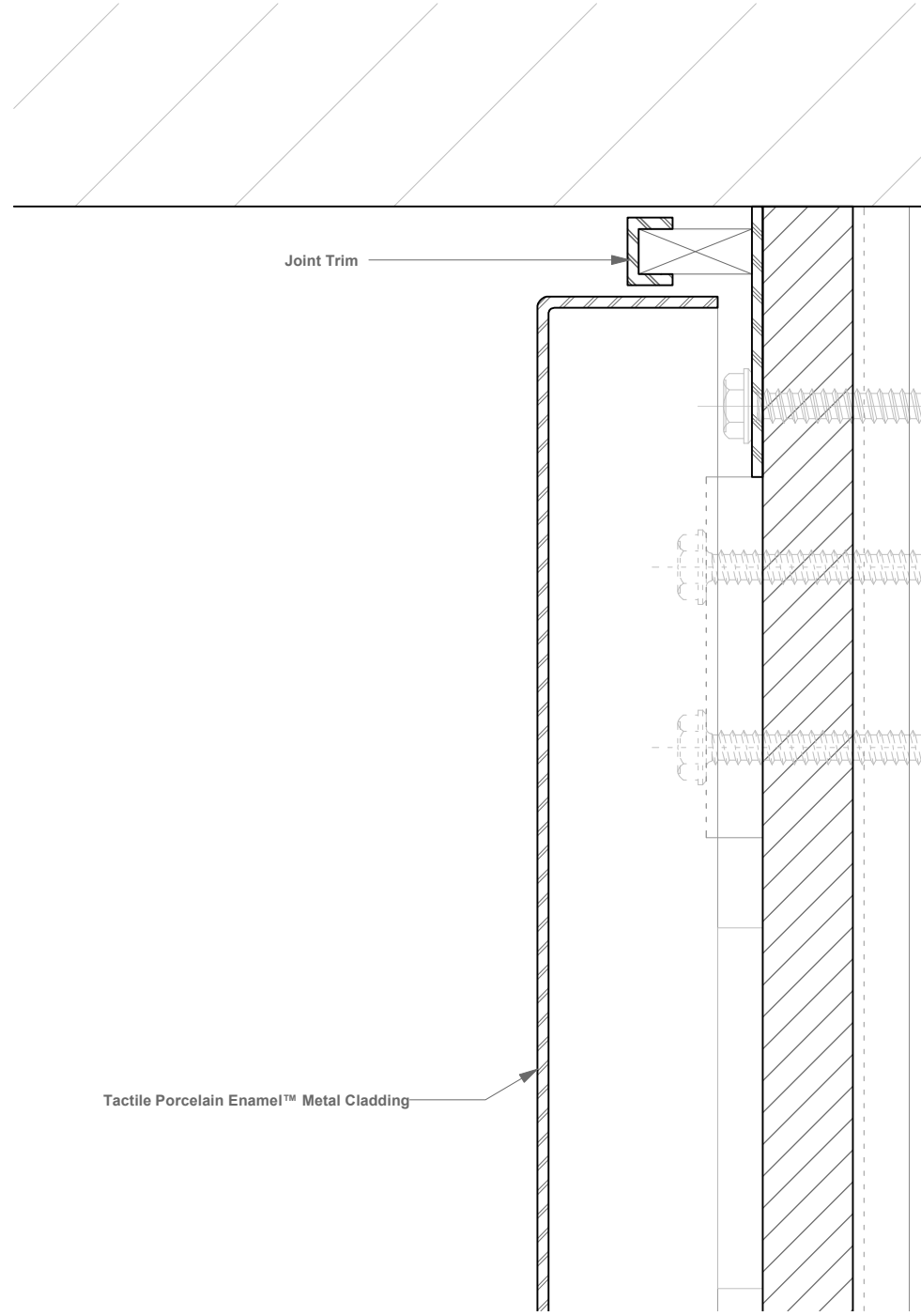

1 Section - Typical Horizontal Joint at Ceiling - Tactile Porcelain Enamel™ Metal Cladding
 M-04 Scale: Full Scale

SHEET NO. M-04	REVISIONS			PROJECT#	ARCHITECT	CLIENT
	SCALE AS NOTED	DESCRIPTION	DATE			
DRAWN BY JO				Tactile Porcelain Enamel™ Metal Cladding Details Interior Cladding		
APPROVED BY SE						
ISSUE DATE 11/05/2019						